



Percussion Championships

April 5, 2025

Sherwood High School

Welcome to the 2025 NWAPA Championships. We look forward to a great show!

Day of Show Contacts	Leah Turner, Event Coordinator (503) 332-9868. Stacy Rauch, Judges and Hospitality (503) 803-2868.
WiFi Passcode	sherwood (all lower case)
Performer Passes	All student performers will receive a wristband at the time of unit Check-In.
Staff Passes	All units will be supplied with 7 wristbands at Check-In that will serve as staff passes. If you have volunteers helping your team, they will not be allowed on the floor without a wristband. At Check-In, each unit has the option of purchasing up to 10 additional wristbands (purchased in bulk) at the discounted rate of \$10 each. Any person not wearing a wristband will be directed to the ticket table to purchase one. This rule will be strictly enforced.
Event Staff	This event is hosted and staffed by Sherwood Band Boosters. If you have any questions or require assistance throughout the day, please look for a volunteer wearing a "Show Host" t-shirt or yellow vest. Volunteers at the Unit Check-In Table will also be available to help.
Admissions	\$20 General admission. Children 3 and under are free. Please note that the main spectator entrance has changed. It is now located on the opposite side of the building and much closer to Spectator Parking. Units and volunteers with wristbands can still use the previous entrance to access concessions, vendors, spectator viewing, etc. (SHS Front Doors)
Unit Check-in and First Aid	Unit Check-in and the First Aid Station will be located in the hallway just inside the SHS Front Doors.

Concessions	Hot food (including pizza), snacks, and drinks will be available at concessions located just outside the spectator entrance to the Performance Area (Main Gym). Concessions Stands will be open throughout the entire event.
Changing Areas	Restrooms will serve as the changing areas for the performers. Please help us keep these areas clean and orderly. Stadium restrooms, outside near the percussion camp sites, will be open and available for use.
Videotaping	NWAPA will be providing professional video recording services this year. Units may videotape their own performances for educational use. Anyone video recording a particular unit must receive permission from the unit's director.
Floor folding area access	<p>The floor folding area is in the upper gym (same location as previous years). However, this year the elevator will be available to take your floor and cart to the 2nd floor. Although the stairs are still an option, please feel free to place your floor on the cart and send it up using the elevator.</p> <p>The elevator door is 41" and the elevator is 69" long. Carts wider or longer than this WILL NOT FIT.</p> <p>(All students except for the one pushing the cart still need to take the stairs.)</p>
Program	This year's program is exclusively digital. Please use the QR code on next page to access.
Payment Methods	Cash and all major credit cards will be accepted.
Full Retreat	<p>After the last Finals performance, all units report to the Prop Storage hallway and line-up at the sign with your unit name.</p> <p>Seniors/Age-outs will receive their medals WHILE IN LINE and should wear them while marching in for awards. Seniors/Age-outs will be recognized once all units are in place in the gym.</p>
Buses	NO buses can turn into the West Unit Camp Lot. Buses for Units with camps in that lot must use the bus turn-around to drop-off performers. See Bus Route map. From Elwert Rd, turn onto Krueger Rd at the round-about. Continue on Kruger past the baseball fields and turner right into the parking lot. Take first right in the lot after the baseball fields to access the bus lane/turn-around.

SHERWOOD WINTER SHOWCASE



**ACCESS OUR DIGITAL
PROGRAM!**

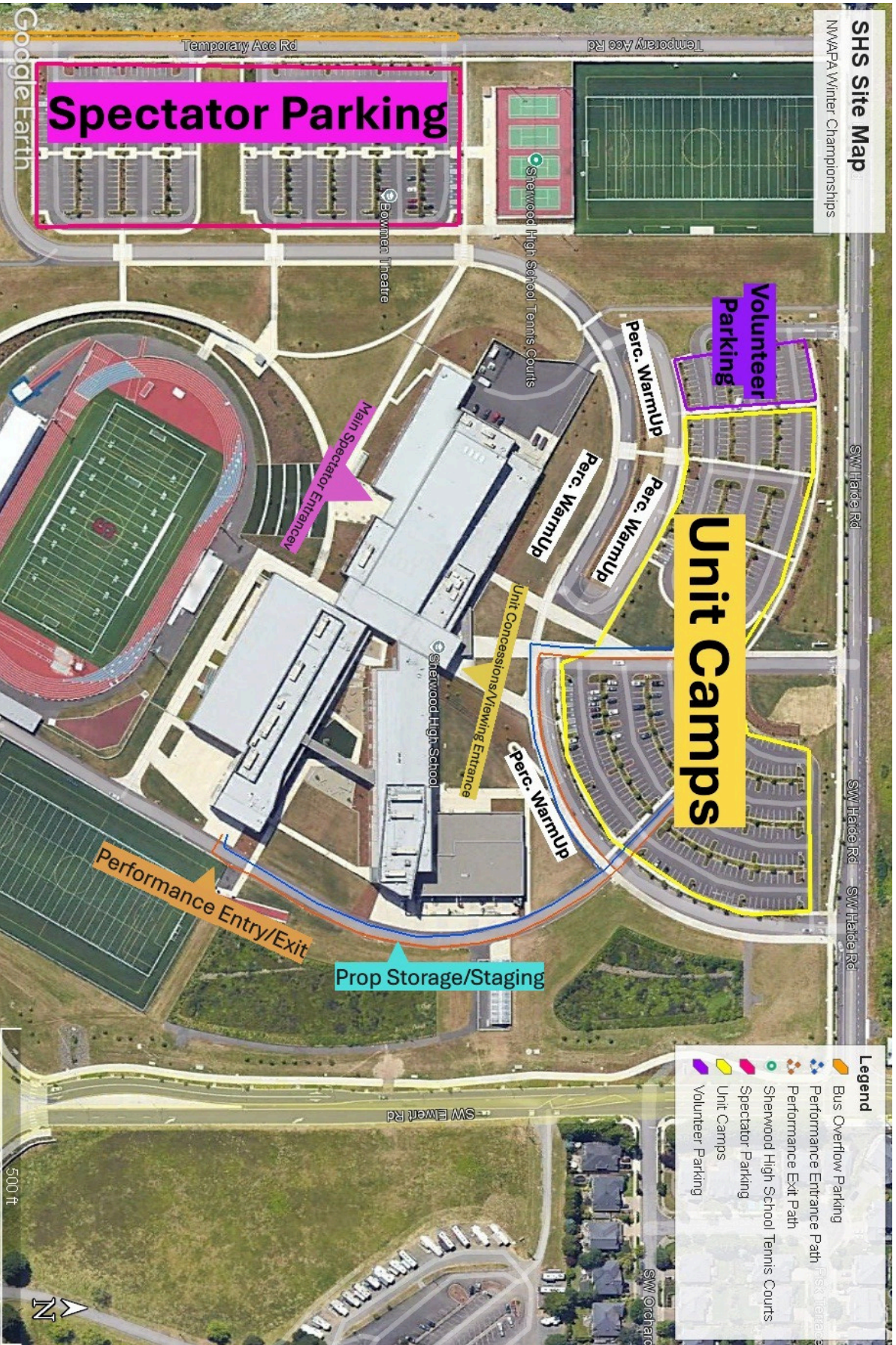

Unit Camp Map

NWAPA Winter Championships



Bus Dropoff Route NWAPA Winter Championships

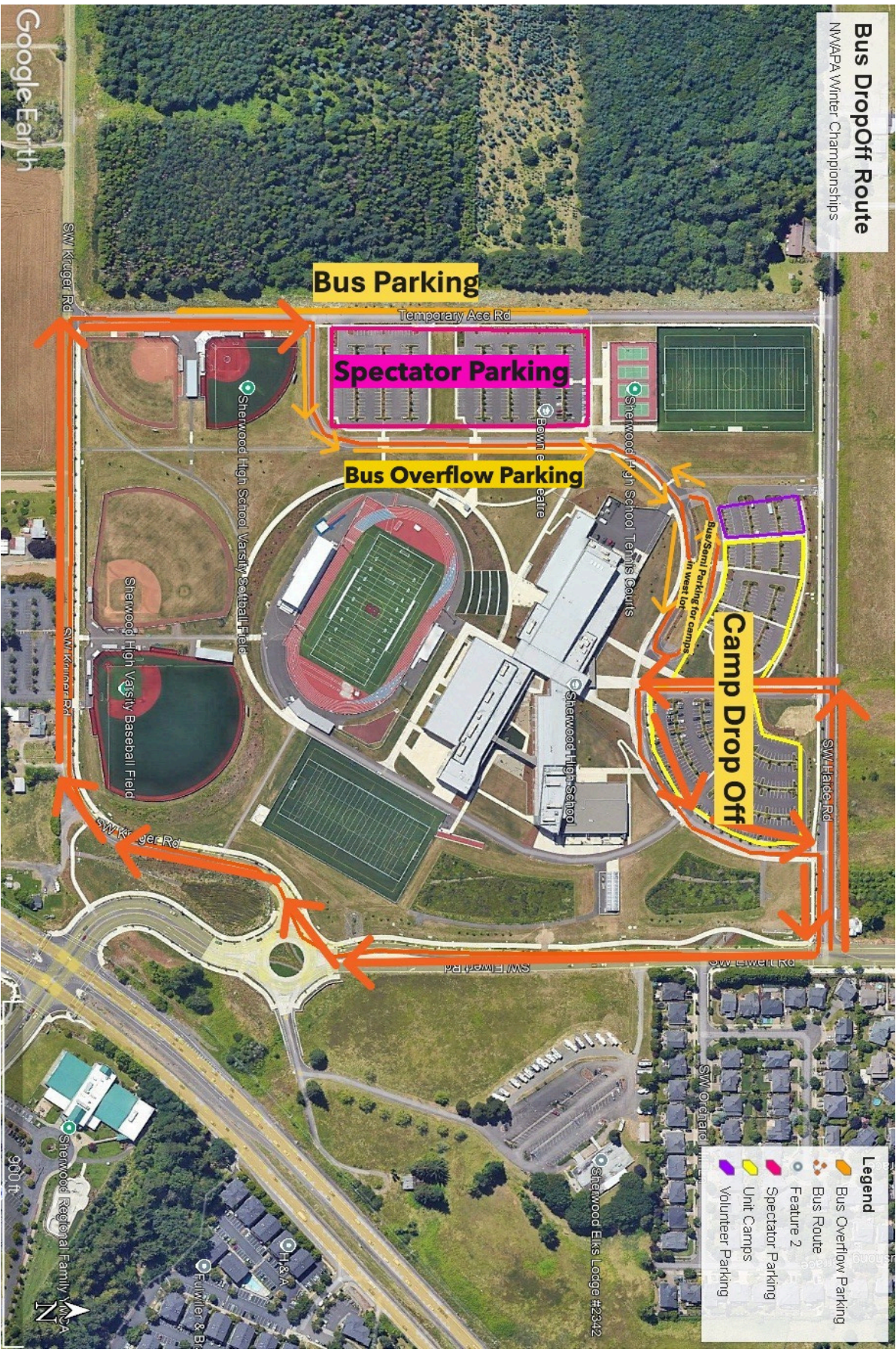

Legend

- Bus Overflow Parking
- Bus Route
- Feature 2
- Spectator Parking
- Unit Camps
- Volunteer Parking

Performance Floor Flow Map

MAIN GYM

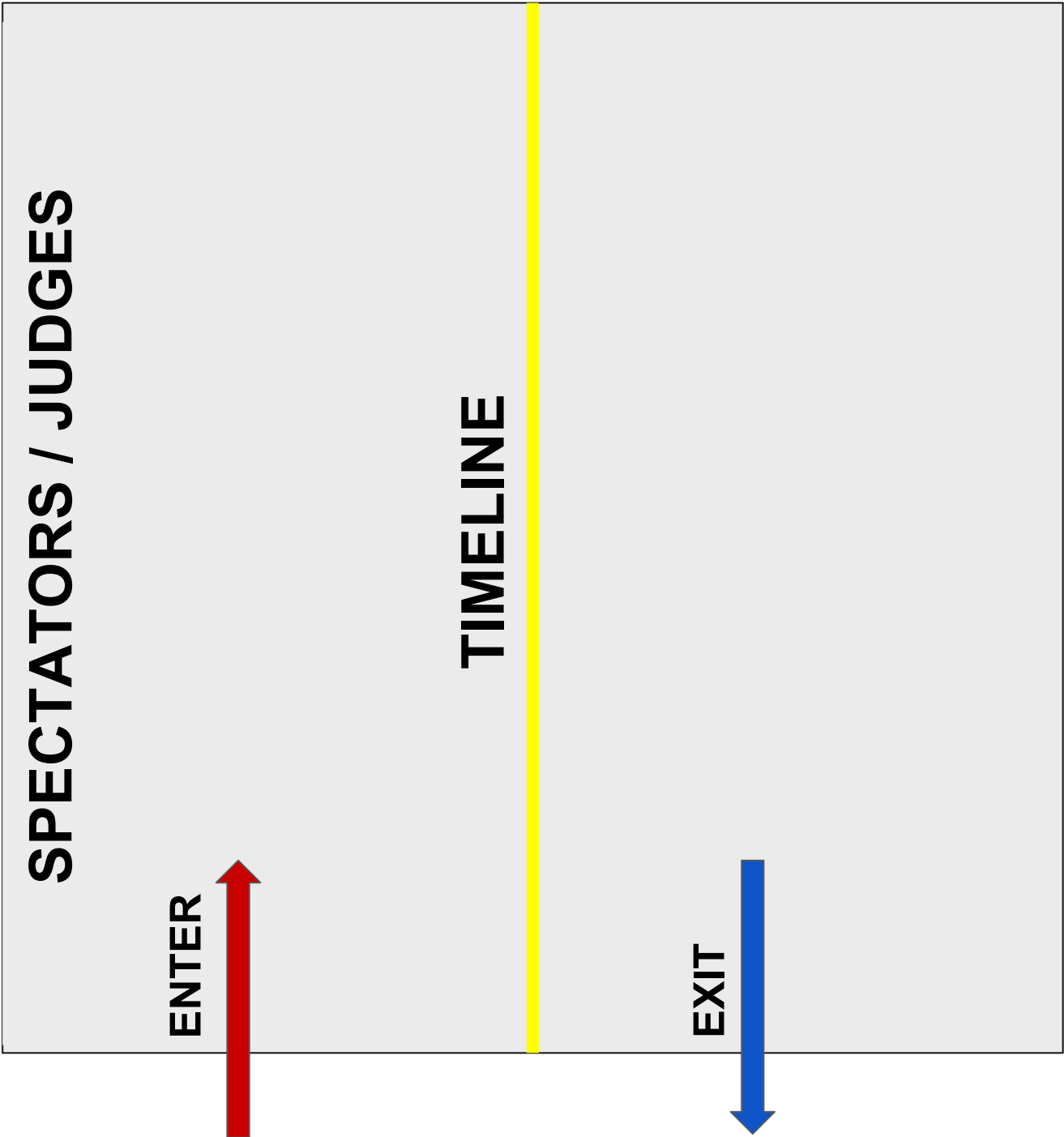

Floor Folding Flow Map

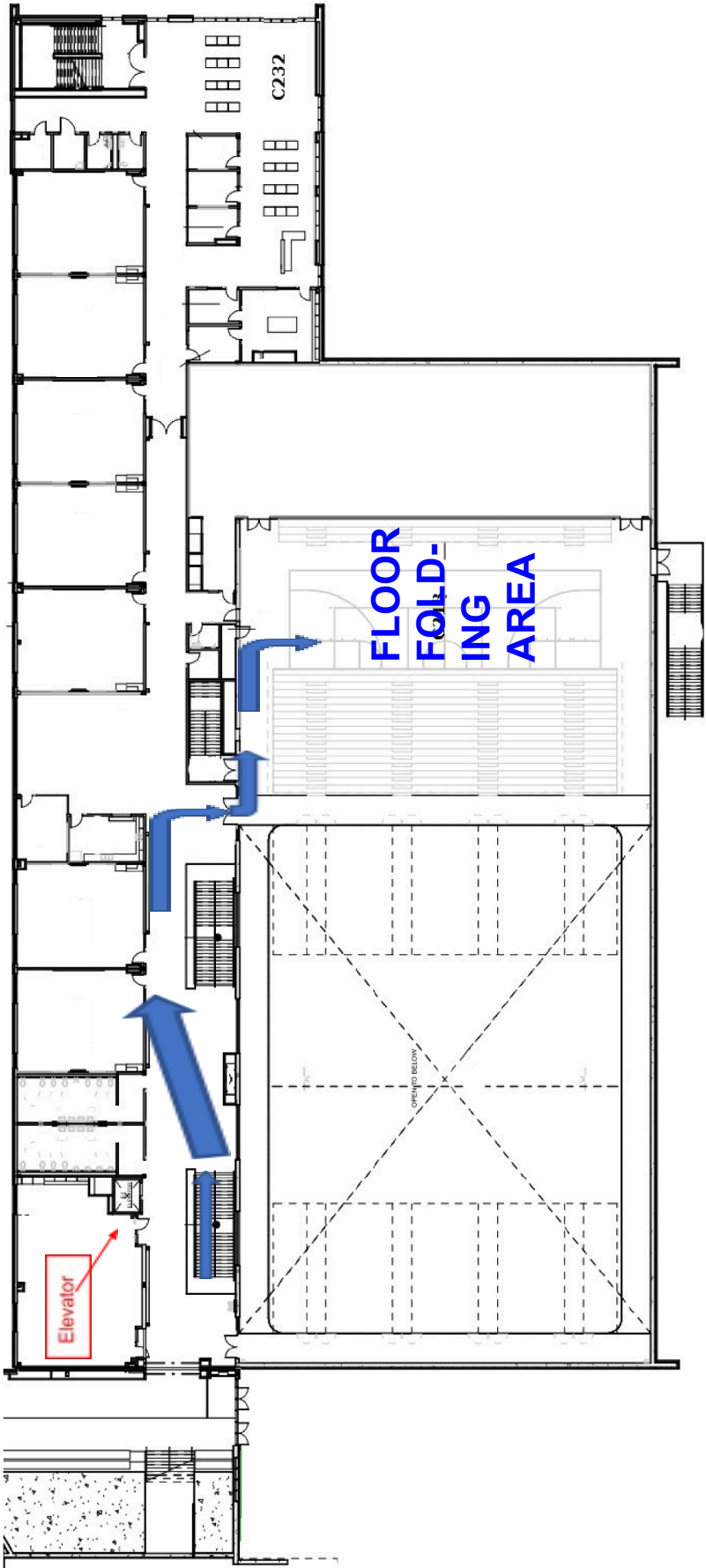

Please Note – Floor will be brought upstairs to Auxiliary Gym to fold – floor cart will be brought up in the elevator

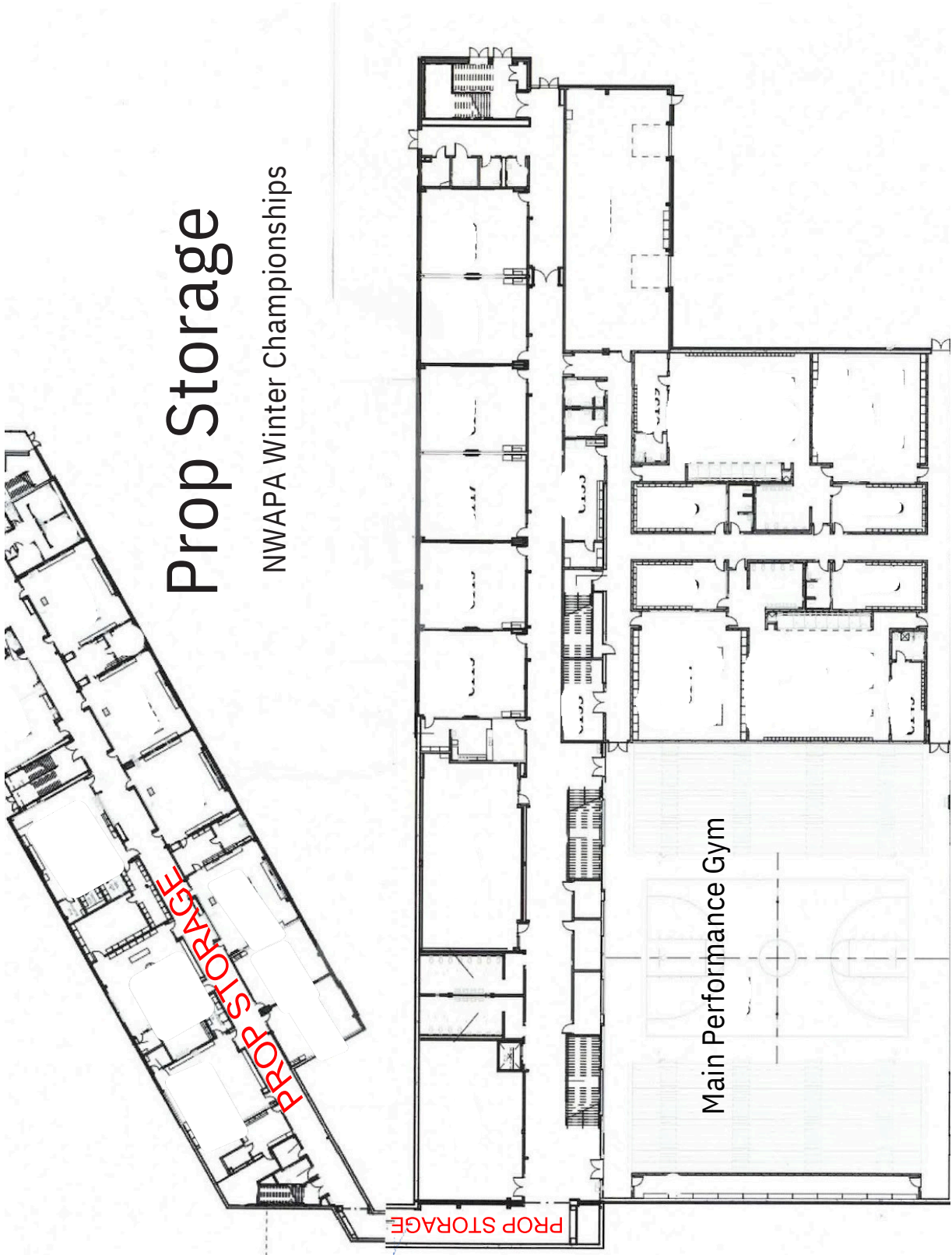

Prop Storage

NWAPA Winter Championships

